

VWH-NT (non-touch)

Video wall mount

Item no.: 1751

The innovative Full Service Video Wall Mount VWH-NT is a mounting system to create video walls. Because of the modular design almost unlimited video wall configurations are possible. The video wall mount VWH-NT is optimized for the latest generation of video wall screens without, or with only a very narrow frame.

The pop-out system utilizes an innovative and proprietary mechanism that allows to move every single screen to a operating position without having pressure on the screen. The risk of damage to the screen will be minimized this way.

Thanks to the magnetic lock it is easy to fix the bracket back in the basic position after retracting the display. Even with a necessary replacement of individual devices therefore no disassembly of the entire video wall is necessary. At any time an optimal service accessibility is given.

The VWH-NT brackets can be installed in landscape as well as portrait orientation, the pull-out adapter for

Landscape is included, the pull-out adapter for portrait is available as an optional accessory.

As standard, the VWH-NT includes the VESA standards 200 × 200 mm, 300 × 300 mm and 400 × 400 mm, these can optionally be extended with an adapter set up to VESA 600 or VESA 800 (included). The carrying capacity is 40 kg max..

In addition, a fine adjustment of the screens in three dimensions is possible. With the 8-point level control for depth and height, as well as the ability to move the screens to the right and left and lock at the desired point, the individual display surfaces can be optimally coordinated to create a smooth split.

As a special feature optional mounting templates (device specific) are available. The drilling template based on the display model generates the exact distance to the adjacent horizontal and vertical mounting, which will minimize the installation time. The device list can be found on our website (www.hagor.de).

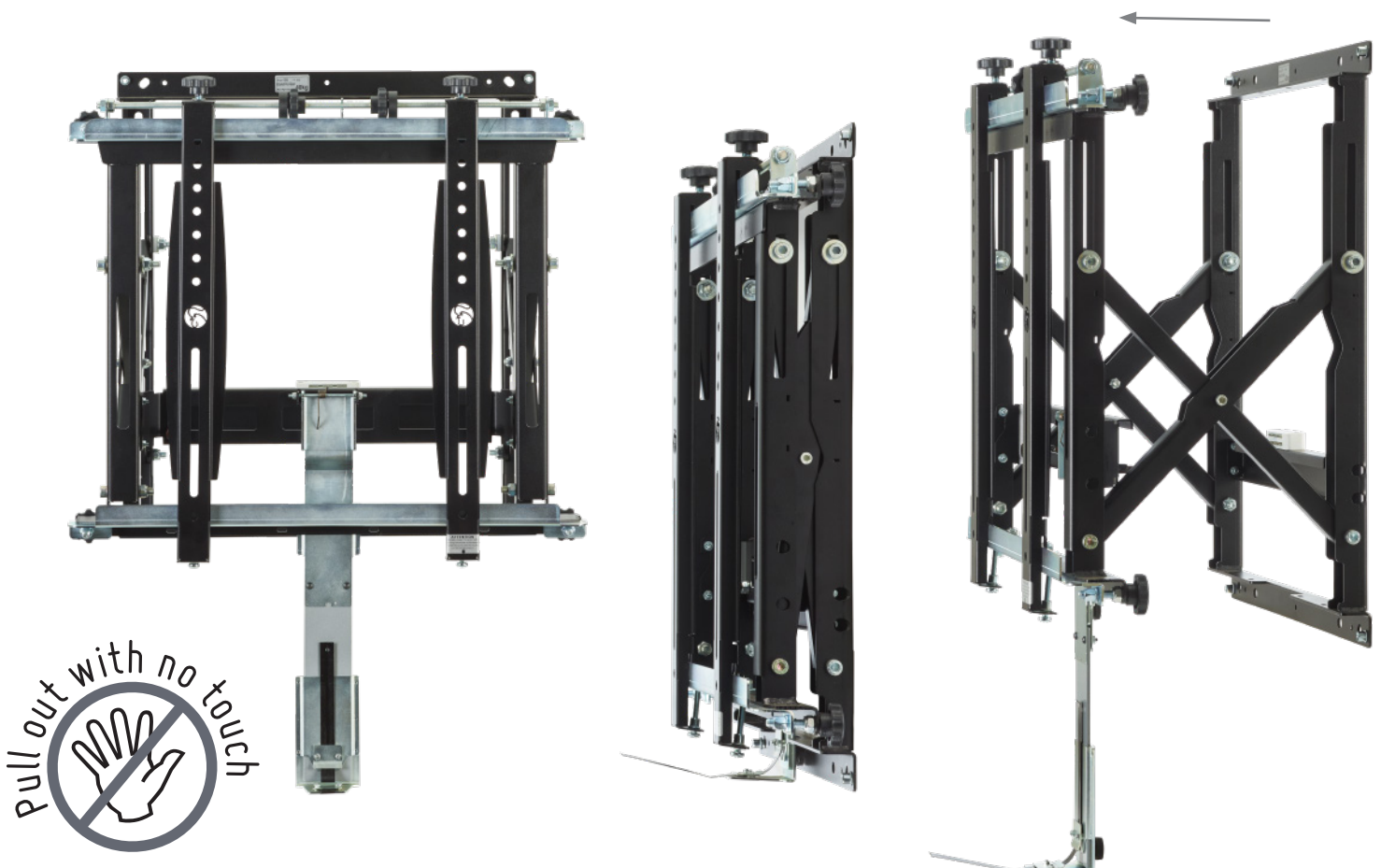

Technical changes reserved

VWH-NT (non-touch) Video wall mount

Item no.: 1751

- for screens from 42 - 55" / 107 - 140 cm
- max. load 40 kg / weight 12,5 kg
- Landscape pull-out adapter included,
Portrait pull-out adapter optional (Item no.: 5037)
- incl. VESA standard,
VESA 200 x 200 up to 400 x 400 mm
incl. adapter set for 600 x 400 or 400 x 600 mm
- distance to wall - 96 mm min. - 286 mm max.
(fine adjustment by ± 5 mm)
- fine adjustment without tools
- optimized service accessibility
- Modular construction allows unlimited Video wall configurations
- robust crossbar technology
- the special technology with a magnetic mechanism allows to extract the bracket without pressure on the screen
- optional expandable with
 - Adapter bars to VESA 800 (Item no.: 1469)*
- optional: VWH-ASxxx drilling pattern,
 - Quick installation (Item no.: 1446)



Magnetic lock

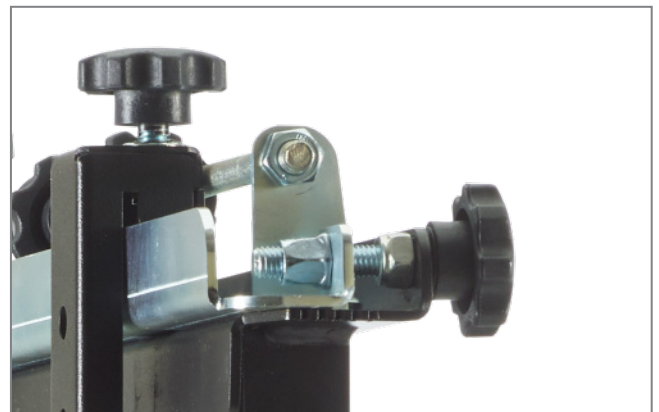

height adjustable up to ± 5 mm (2x),
depth adjustable for up to ± 5 mm (4x)

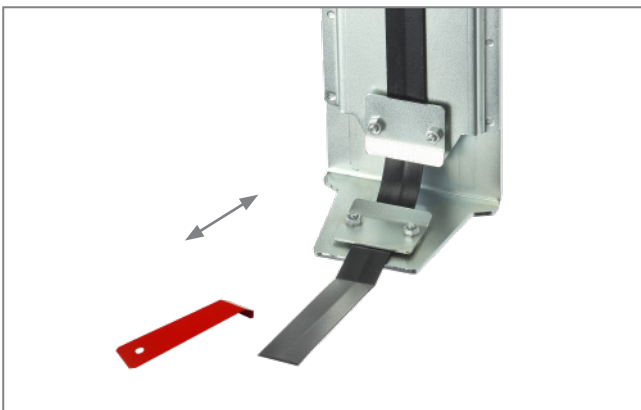

Pull-out tool for easy accessibility (included)
Optional: Portrait pull-out adapter (Item no.: 5037)



robust crossbar technology

VWH-NT (non-touch)

Video wall mount

Item no.: 1751

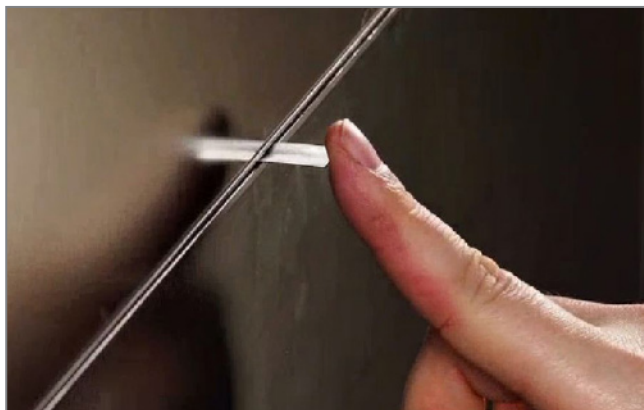

Bracket insertable



incl. Pull-out tool (Hook)

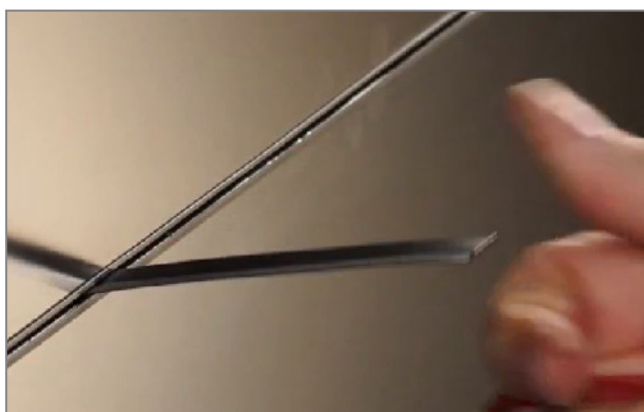

Extending the bracket without pressure on the screen



Also manual release possible



Scan to see the product video

Item no.: 1751

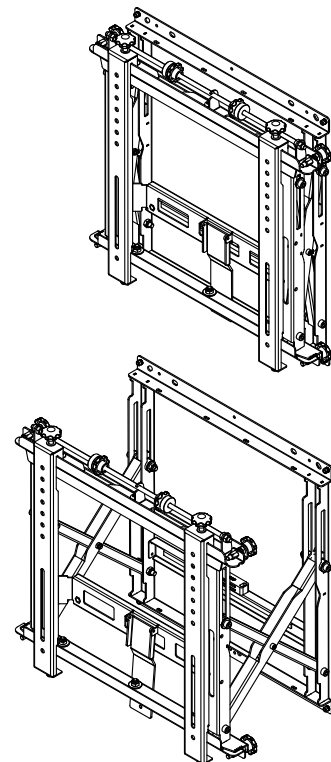

VWH-NT (non-touch)

Video wall mount

Item no.: 1751

INCLUDING: Landscape pull-out adapter

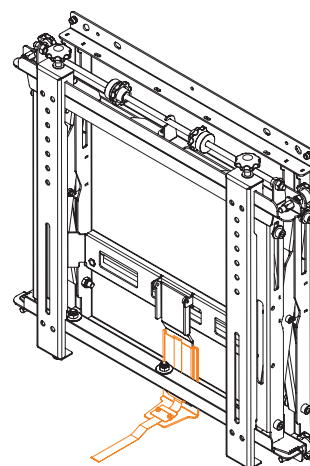
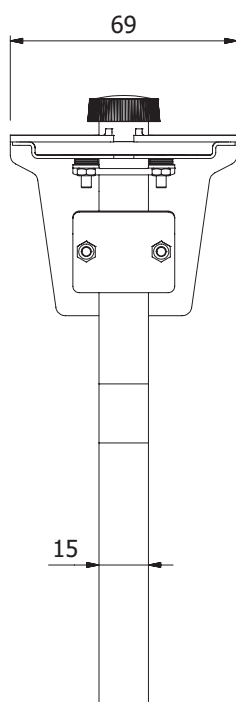
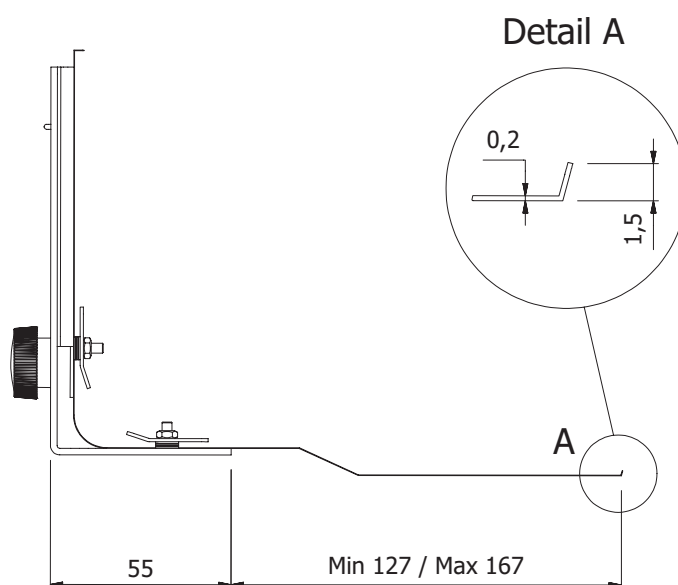
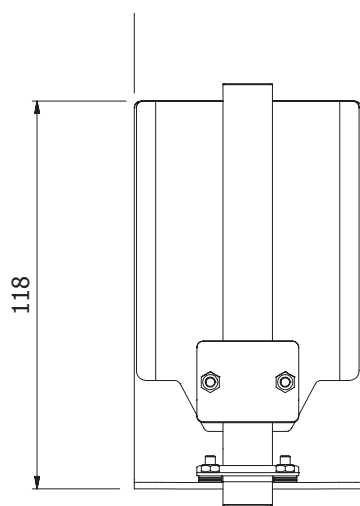

VWH-NT (non-touch)

Video wall mount

Item no.: 1751

OPTIONAL: Portrait pull-out adapter (Item no. 5037)

